

Starting Treatment

This procedure is not intended to replace your doctor's, practitioner's, or peritoneal dialysis (PD) nurse's advice or training. Refer to the *Liberty® Select User's Guide* for detailed information including device description, instructions, contraindications, warnings, and precautions. As with all PD procedures, use aseptic technique. This information is provided for QUICK REFERENCE only.

Note: All pictures are for example only.



- Make sure the cyclizer is plugged into a grounded outlet.
- If using the IQdrive™, insert it into the USB port. When facing the front of the cyclizer, the USB port is located on the back left side.
- Turn on your cyclizer using the white power switch on the back of the cyclizer.

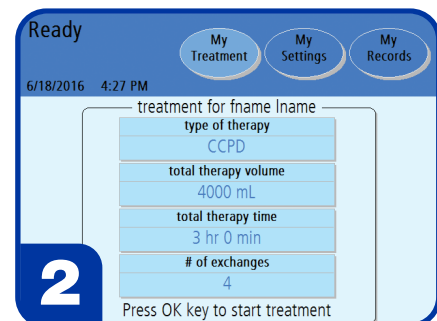

- To make any changes to the therapy, patient, or hardware settings, press **My Settings**.
- Return to the Ready screen and make sure your prescription information is correct.
- Press **OK** to start treatment.

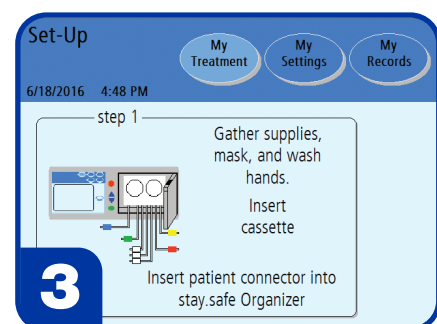

- Gather supplies:
 - Solution bags (Check S.C.A.L.E.)* - stay•safe caps
 - Liberty cyclizer set - Drain line(s) or drain bags
 - stay•safe® organizer - Hand sanitizer
- Mask and wash hands.

* Solution, Clarity, Amount, Leaks, Expiration Date

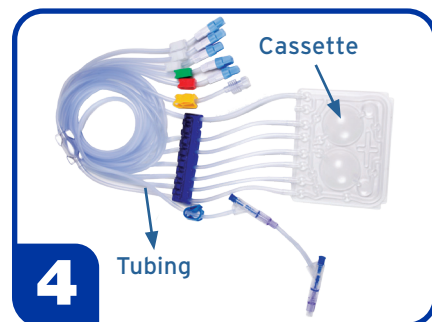

- Check the package label on the Liberty cyclizer set to ensure it is not past its expiration date, and then remove the cyclizer set from its packaging.
- Inspect the Liberty cyclizer set to make sure it is free from kinks or damage. Look for scratches, loose tubing, or small holes in the cassette film.

⊗ Caution: Use caution when touching the cassette film to prevent damage.

⚠ Warning: A damaged cassette can cause PD solution to leak into the cyclizer and is a potential risk for contamination. Notify your PD nurse if you find a fluid leak.

⚠ Warning: DO NOT USE the cassette if it is damaged. Call Customer Service at 800-323-5188 to arrange a pick-up to return the damaged set.



- Firmly push the door latch to open the cassette door.

⊗ Caution: Avoid touching any of the sensors inside the cassette door, as this could cause damage to the pump module.

⊗ Caution: The cassette door is pressurized. Do not attempt to open the cassette door until your machine instructs you to do so.

⚠ Warning: Check that the pump module is clean and free from obstructions before inserting the cassette. Keep fingers clear of moving parts.



- Hold the cassette with the plastic domes facing outward (towards you).
- First, slide the cassette up and under the cassette guide pins.
- Then, snap the cassette in place using the cassette catch at the bottom of the pump module.

The cyclizer operates the same with or without an alignment bar. The same cassette insertion technique should be used for cyclizers with or without an alignment bar.



- Make sure the cassette is resting under the cassette guide pins at the top of the pump module and within the catch at the bottom of the pump module.
- If your cyclizer HAS an alignment bar, the tubing should hang down in front of the cyclizer over the alignment bar.
- If your cyclizer DOES NOT HAVE an alignment bar, the tubing should hang freely down in front of the cyclizer.



- If using a cyclizer cart, be sure the cyclizer tubing is hanging down behind the handle of the cart.
- If using a nightstand, make sure the tubing is hanging down freely over the front of the nightstand.
- Insert the blue stay•safe PIN connector into the stay•safe organizer clip below the control panel.

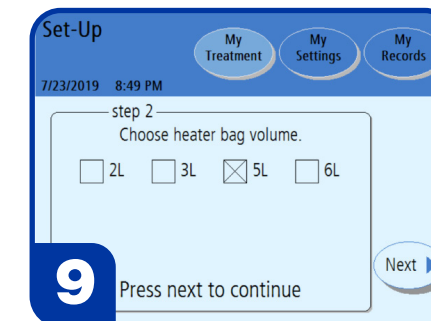

- Gently close the cassette door. Ensure the cassette door clicks into place to lock it.
- Your cyclizer will pressurize the cassette door and then display the next step of the setup process (as pictured to the left).

⊗ Caution: Do NOT force the door closed. If you're having trouble closing the door, open the cassette door and make sure the cassette has been inserted correctly.

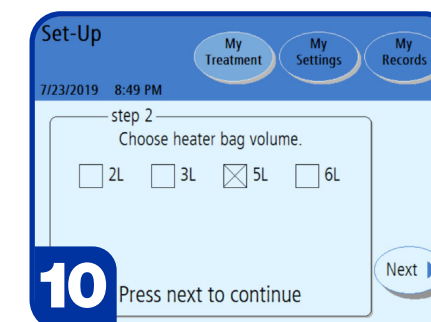



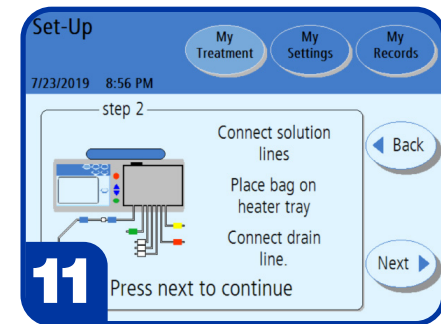

When directed:

- Choose your heater bag volume (2L, 3L, 5L, 6L).
- The bag you use must be at least 1000 mL larger than your first fill volume and at least as much as your maximum fill volume.

i Note: Place the solution bag with the largest volume on the heater tray.



When directed:

- Connect the heater bag to the line with a  RED clamp.
- Connect additional solution bags to lines with a  WHITE clamp.
- Connect the last bag to the last bag option with a  GREEN clamp, if required.
- Connect the drain line or drain bags to the line with a  YELLOW clamp.
- Ensure that only one solution bag, which is the heater bag, is placed evenly on the heater tray.
- Press **Next**.



When directed:

- Break the cones on the heater and solution bags with fingers or stay•safe Handi-tool.
- Bend cone back and forth until completely separated.
- Clamp solution lines that are not connected to a bag.
- Press **Next**.

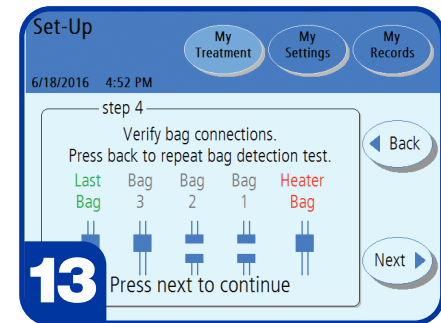

- Verify all solution bag connections match those on the screen.
- Press **Next**.
- The cyclor will now flush the solution/drain lines.

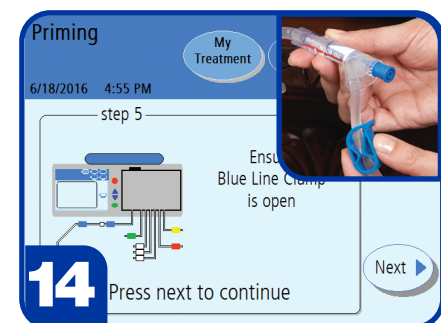

- Verify that the blue clamp on the patient connector line of the cyclor set is open.
- Press **Next** to prime the patient line on the cyclor set (line with the blue clamp).

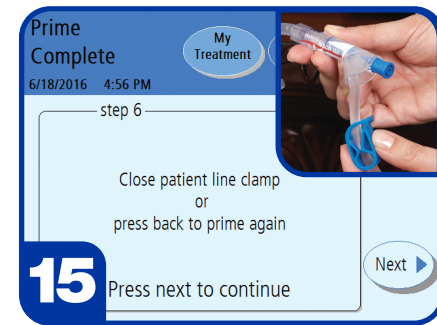

- When priming is complete, inspect the patient line (line with the blue clamp) and PIN connector on the cyclor set to ensure it is completely filled with fluid.
- If you do not see fluid in the PIN connector, press **Back** to prime again, as necessary.
- Close the blue clamp and press **Next**.

Note: If you are using a Liberty cyclor set tubing model (P/N 050-87216) with a 20-foot long patient line, you may need to press the **Back** button again to ensure the line is fully primed.

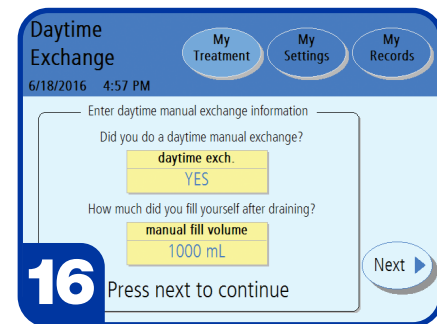

- Enter **Yes** if you filled your abdomen with solution without using the cyclor (manual exchange).
- Enter the fill volume from your manual exchange. Press **Next** to continue.
- Review the settings just entered and then press **Next** again.

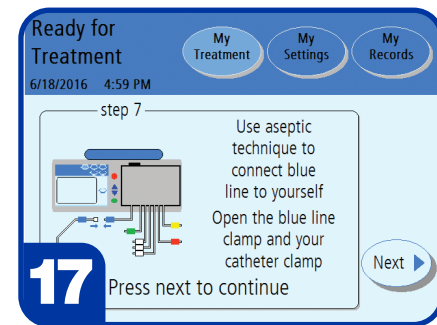

- When prompted on the Liberty cyclor screen, prepare to connect your PD catheter to the PIN connector (blue clamp).
- For aseptic technique, follow the instructions provided by your PD nurse about wearing a mask and sanitizing or cleaning your hands just before connection.
- Once you are connected, open both the white clamp on your PD catheter extension set and the blue clamp on the patient line of the cyclor set.
- Press **Next** to continue. Your treatment will now begin.

For technical questions, please call Technical Support anytime at 800-227-2572. For medical or clinical questions, call your home therapy nurse or nurse on call.

Read the Instructions for Use for safe and proper use of this device. For a complete description of hazards, contraindications, side effects, and precautions, see full package labeling at www.fmcna.com

Indications for Use: The Fresenius Liberty Select cyclor is indicated for acute and chronic peritoneal dialysis.

The Fresenius stay•safe patient connectors are intended for use with a peritoneal cyclor for drainage and infusion of PD solution during a peritoneal dialysis exchanges. The Fresenius stay•safe patient connectors are indicated for use in acute and chronic peritoneal dialysis.

Caution: Federal (US) law restricts this device to sale by or on the order of a physician.



Fresenius Renal Technologies, a division of Fresenius Medical Care North America
Waltham, MA 02451
Assembled in Mexico
Customer Service: 800-662-1237 | Technical Support: 800-227-2572