

Initiating Treatment

This procedure card is not intended to replace the advice or training from your Doctor or Peritoneal Dialysis (PD) Nurse. Please refer to the Liberty PDX™ Cyclor User's Guide (P/N 480054) for detailed information on device description, instructions, contraindications, warnings, and precautions. With this and all other PD procedures, always maintain aseptic technique. This information is provided for quick reference only. Please follow the directions as they appear on the Liberty PDX cyclor screens. Wait for your prompts to the next step. **Note:** All pictures are for example only.

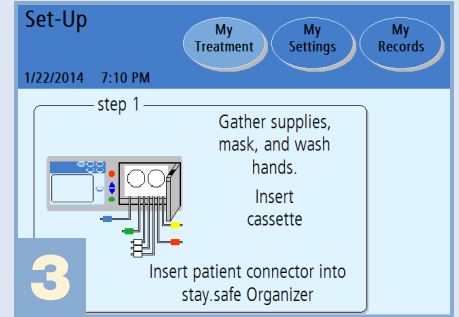
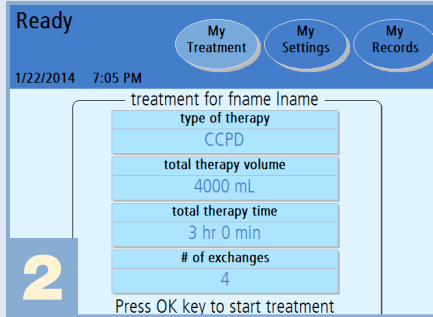

- Make sure the cyclor is plugged into an outlet.
- If using the IQdrive™, insert it into the USB Port located on the backleft side of the Liberty PDX cyclor when facing the front of the cyclor.
- Turn on your Liberty PDX cyclor using the white power switch on the back of the cyclor.

- To make any changes to the therapy, patient, options, and hardware, make them now by pressing **My Settings**.
- Return to Ready screen and make sure your prescription information is correct.
- Press **OK** to start treatment.

- Gather supplies:
 - Solution bags (Check S.C.A.L.E.*)
 - Liberty PDX cyclor set
 - stay•safe® organizer
 - stay•safe caps
 - Drain line(s) or drain bags
 - Hand sanitizer
- Mask and wash hands.

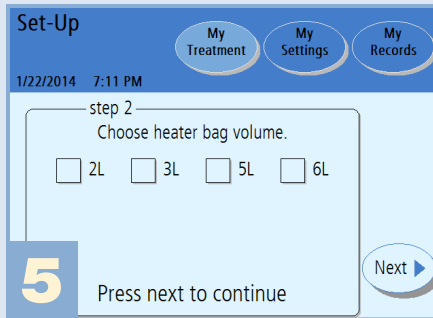
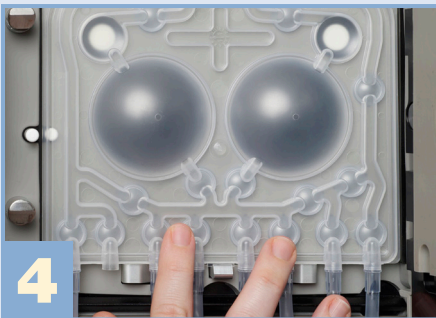

- Prior to insertion, inspect cassette tubing, film and cups for possible damage.
- Carefully insert the top portion of the cassette first, then press the lower portion in until it snaps securely and close the door.
- Lines must be hanging straight down.
- Insert the patient line with blue clamp connector (trigger) into the stay•safe organizer.
- Press **Next**.

- When directed:
- Choose heater bag volume:
 - 2L, 3L, 5L or 6L
 - The bag you use for your heater bag must be at least 1000 mL more than your first fill volume and at least as much as your maximum fill volume.

- When directed:
- Connect **RED** line to heater bag.
 - Connect **GREEN** line to last bag option or additional supply bag.
 - Connect **WHITE** lines to additional supply bags.
 - Connect **YELLOW** line to drain line or drain bags.
 - Ensure heater bag is placed evenly on heater tray.
 - Press **Next**.

* Solution, Clarity, Amount, Leaks, Expiration date

Initiating Treatment (continued)



7

When directed:

- Break cones on the heater and solution bags with fingers or stay•safe handi-tool.
- Bend cone back and forth until completely separated and float the cones.
- Clamp unused lines.
- Press **Next**.

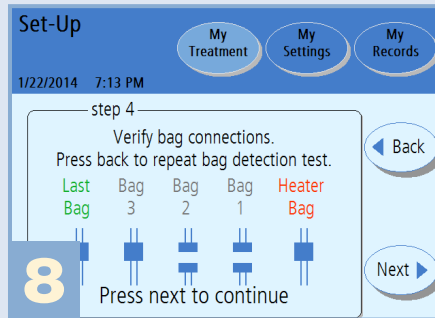

8

- Bag detection test shows which lines are connected to solution bags.
- Connected bags have unclamped lines. Unconnected bags have clamped lines.
- Verify your bags match those on the screen.
- Press **Next**.

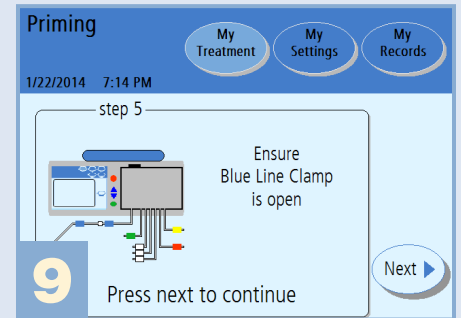

9

- Verify that the blue clamp is open.
- Press **Next** to prime the patient line with blue clamp.

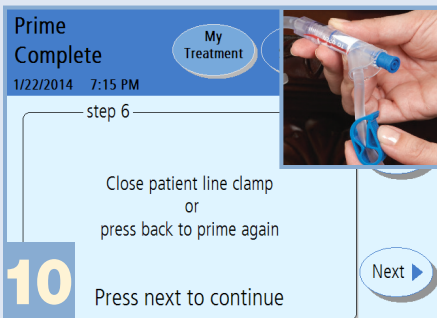

10

- When priming is complete, inspect the patient line with blue clamp to ensure it is completely filled with fluid.
- Press **Back** to prime again, as necessary.
- Close the blue clamp and press **Next**.

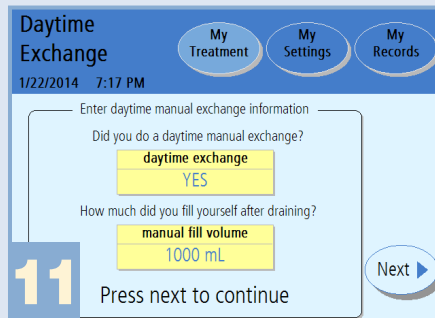

11

- Enter **YES** if you filled your abdomen with solution without using the Liberty PDX cyclor (manual exchange).
- Enter the fill volume from your manual exchange. Press **Next** to continue.
- Review the settings just entered and then press **Next** again.

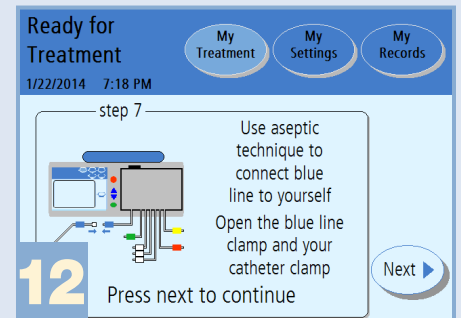

12

- Once you are connected, open both catheter and patient line blue clamp.
- Press **Next** to continue.
- Your treatment will now begin.

Indications for Use: The Liberty PDX cyclor is indicated for acute and chronic peritoneal dialysis.

Caution: Federal (US) law restricts this device to sale by or on the order of a physician.